

Hydro Flow® DIY Hydroponic Systems

Flo-n-Gro® Gro Momma Bubbler Bucket

Can be used singly or in multiples daisy-chained together.

A simple system that expands easily, making filling and draining multiple grow sites easy.

Parts List

QTY	DESCRIPTION	PART #
A 1	3/16" Barbed Tee	10/Bag: 747008 Bulk Ea: 742020
B 1	3/4" Barbed Tee	10/Bag: 747100 Bulk Ea: 742095
C 1	3/8" Rubber Grommet	10/Bag: 747042 Bulk Ea: 708376
D 1	3/4" Rubber Grommet	10/Bag: 747116 Bulk Ea: 708380
E 2	3/4" EZ Pull End Caps	10/Bag: 747120 Bulk Ea: 708598
1	Clear Vinyl Tubing (3/16" I.D. / 1/4" O.D.) 100' Roll Cut Pieces: F 1@30" G 2@9"	708215
H 1	Gro Pro® Black Plastic Bucket 5 Gallon	724380
I 1	Gro Pro® Mesh Pot/Bucket Lid 8"	724530
J 1	EcoPlus® Eco Air 2 Pump (2 Outlet, 3 Watts, 126 GPH)	728360
K 1	EcoPlus® 4" Air Stone	728430



System Diagram

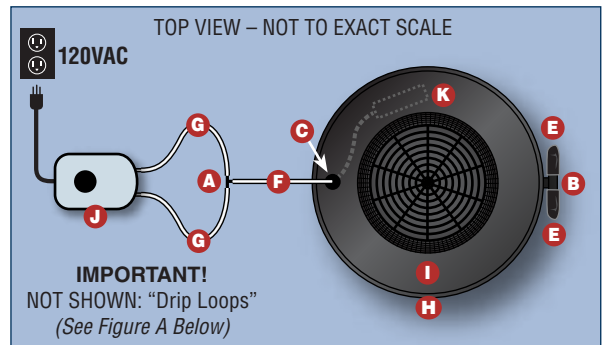

Assembly Instructions

1. Drill a 1" hole about 3/4" from the bottom of the bucket and a 1/2" hole in the middle of the rim of the mesh pot/bucket lid. Install 3/4" grommet into hole in bucket and 3/8" grommet into hole in mesh pot/bucket lid (lubricate lightly with vegetable oil before installation).
2. Install 3/4" tee into 3/4" grommet on the bottom of the bucket (lubricate end going through grommet lightly with vegetable oil before installation). Cover each exposed end of the tee with EZ Pull End Caps.
3. Install two 9" pieces of 3/16" Clear Vinyl Tubing onto air pump. Insert other ends onto 3/16" barbed tee. Connect 30" section to 3/16" tee and run through grommet in Mesh Pot/Bucket Lid, allowing enough length to reach the bottom of the bucket. Attach air stone to end of tubing.

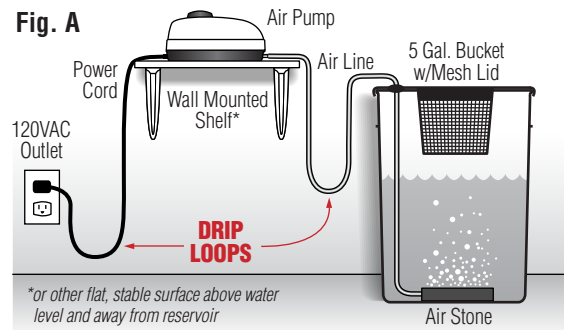
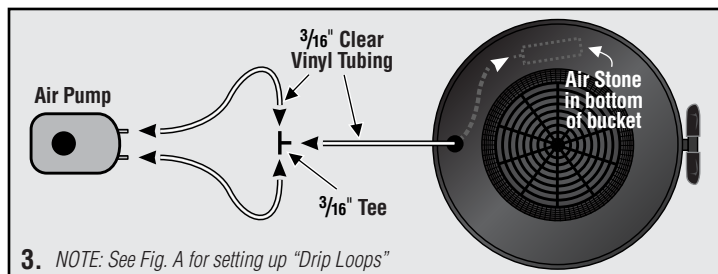
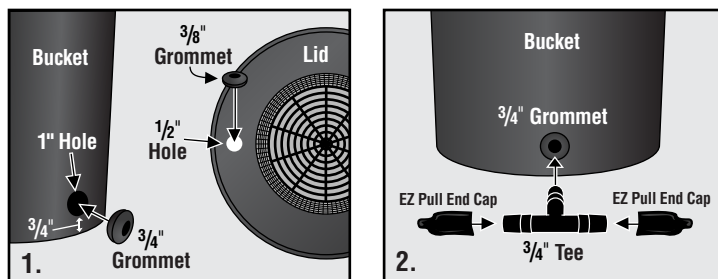

Operation

1. Secure Air Pump on flat, stable surface above the water level in bucket and make sure "Drip Loops" are set up as shown in Fig. A.
2. Fill bucket to desired level with water/nutrient solution and check each fitting to make sure there is no leakage.
3. Plug Air Pump into 120VAC outlet and turn on. With Mesh Pot/Bucket Lid removed, make sure water/nutrient solution is at the correct level and the Air Stone is emitting properly.
4. Replace Mesh Pot/Bucket Lid, fill with desired grow media and you're ready to grow!