

Hydro Flow® DIY Hydroponic Systems

Flo-n-Gro® Big Momma Bubbler Bucket

Use singly or in multiples daisy-chained together.

A simple system for larger plants that expands easily, making filling and draining multiple grow sites easy. A length of blue tubing (mounted externally) makes it easy to tell reservoir level at a glance.

6.6
Gallon
Plant
Site(s)

Parts List

QTY	DESCRIPTION	PART #
A	1 3/16" Barbed Tee	10/Bag: 747008 Bulk Ea: 742020
B	1 3/4" Tub Outlet Tee w/Nut & 2 Gaskets	10/Bag: 747186 Bulk Ea: 742265
C	1 3/8" Rubber Grommet	10/Bag: 747042 Bulk Ea: 708376
D	1 1/2" Rubber Grommet	10/Bag: 747064 Bulk Ea: 708378
E	1 1/2" Barbed Elbow	10/Bag: 747048 Bulk Ea: 742070
F	2 3/4" EZ Pull End Caps	10/Bag: 747120 Bulk Ea: 708598
	1 Clear Vinyl Tubing (3/16" I.D. / 1/4" O.D.) 100' Roll Cut Pieces: G 1@30" H 2@9"	708215
	1 Blue Vinyl Tubing (1/2" I.D. / 5/8" O.D.) 100' Roll Cut Piece: I 1@12"	708260
J	1 Flo-n-Gro® Blue Plastic Bucket 6.6 Gallon	724486
K	1 Flo-n-Gro® 6.6 Gallon Mesh Basket Lid 10"	724490
L	1 EcoPlus® Eco Air 2 Pump (2 Outlet, 3 Watts, 126 GPH)	728360
M	1 EcoPlus® 6" Air Stone	728425



System Diagram

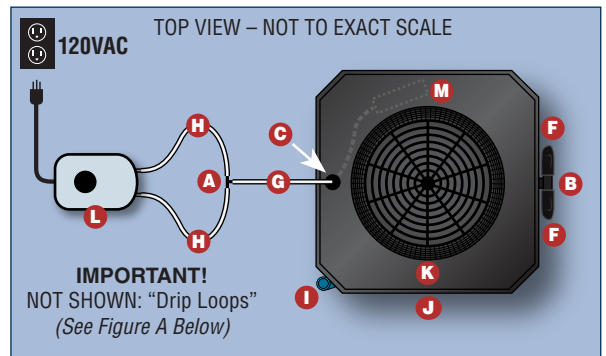

Assembly Instructions

1. Drill a 1" hole in the middle of one wide, flat side of the Bucket, about 3/4" from the bottom and install the 3/4" Tub Outlet Fitting into it. Make sure there's a washer on both inside and outside and do not over-tighten nut. Cover each exposed end of the Tub Outlet Tee with EZ Pull End Caps.

2. Drill a 7/8" hole in the middle of one narrow, flat corner of the Bucket, about 3/4" from the bottom and install 1/2" grommet into it. Drill a 1/2" hole in the middle of the rim of the Mesh Basket Lid and install the 3/8" grommet into it. (lubricate both grommets lightly with vegetable oil before installation).

3. Install Blue Tubing "Level Indicator": Insert 1/2" Barbed Elbow into the grommet you installed in the middle of one narrow, flat corner of the Bucket (lubricate end of elbow going through grommet lightly with vegetable oil before installation). Install 12" length of 1/2" Blue Tubing on elbow. After completing Step #4, secure top end of Blue Tubing with tape, twist tie or other fastening method of your choice to keep it vertical. Water level in reservoir will now show in Blue Tubing so you can check the level at a glance.

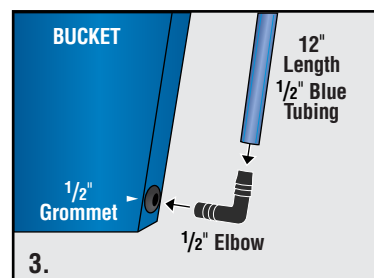
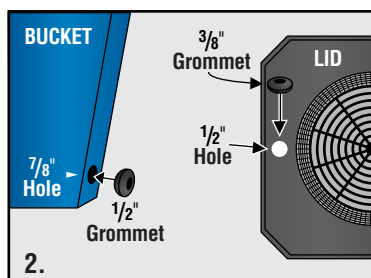
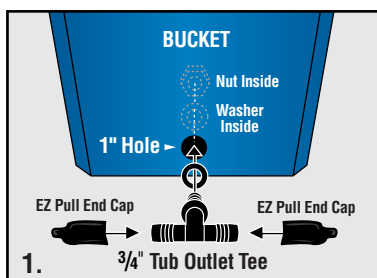
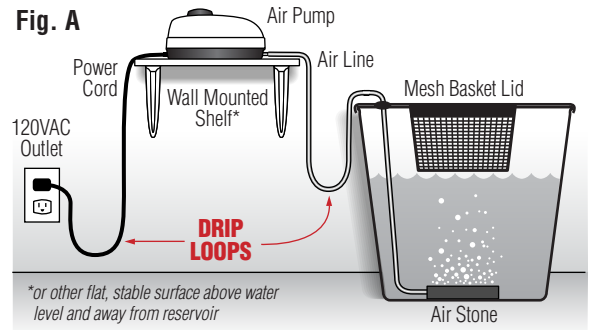

Assembly
Instructions
continued on
next page.

Flo-n-Gro® Big Momma Bubbler Bucket

Assembly Instructions (cont.)

4. Install two 9" pieces of 3/16" Clear Vinyl Tubing onto air pump. Insert other ends onto 3/16" barbed tee. Connect 30" section to 3/16" tee and run through grommet in Mesh Pot/Bucket Lid, allowing enough length to reach the bottom of the bucket. Attach air stone to end of tubing.

Operation

1. Secure Air Pump on flat, stable surface above the water level in bucket and make sure "Drip Loops" are set up as shown in Fig. A.
2. Fill bucket to desired level with water/nutrient solution and check each fitting to make sure there is no leakage.
3. Plug Air Pump into 120VAC outlet and turn on. With Mesh Basket Lid removed, make sure water/nutrient solution is at the correct level and the Air Stone is emitting properly.
4. Replace Mesh Basket Lid, fill with desired grow media and you're ready to grow!

